

COOL  
CALM

REJUVENATING  
PROSPEROUS

SOCIAL

LUXURIOUS

4 bhk high end apartments

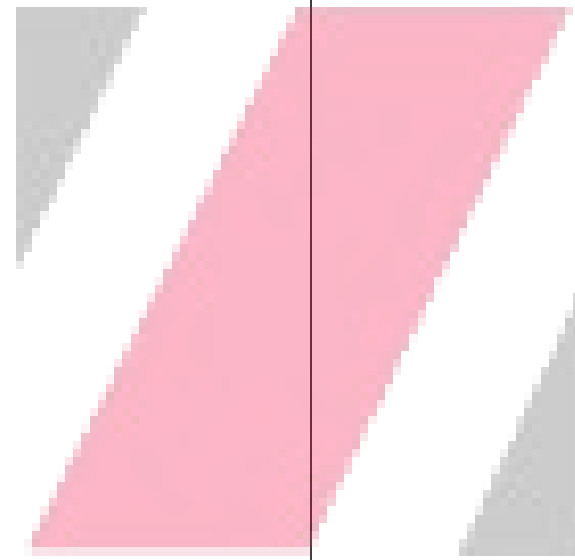

ZRICKS.COM



ROAD TO  
SUCCESS IS  
ALWAYS  
UNDER CONSTRUCTION



 **Goyal  
& Co.** creating  
landmarks  
since 1971  
AHMEDABAD . BANGALORE . MUMBAI

Riviera Blues is brought to you by Goyal & Co. ....The brand that has changed the skyline of Ahmedabad as well as earned the respect of the city with a legacy synonymous with excellence, innovation and transparency. Over the last 4 decades Goyal & Co. has developed more than 190 projects.

Choicest locations, perfect planning and immaculate implementation have ensured value for money for it's customers. Known for delivering beyond the call of duty, Goyal & Co has systematically built on its credibility and goodwill with every project it has launched over the years. Each one being a true testament in innovation, design and construction.

" Riviera " is the high end brand of Goyal & Co and symbolises premium living. Every aspect of Riviera Project is aesthetically crafted. Staying in a Riviera project is a status symbol in Ahmedabad. The journey started with Riviera 11 Bungalows in prahaladnagar followed by Riviera 20, Riviera 30 and Riviera Greens. Contemporary design and masterfully planned spaces have been the highlight of all Riviera projects.

Riviera Heights was the first truly high end apartment project in Ahmedabad. Followed by Riviera Elegance, Riviera Harmony, Riviera Exotica, Riviera Anitlia. Each project has a distinct identity and has been a landmark in its own right. With the same spirit and passion Goyal & Co brings to you - RIVIERA BLUES. ""



each colour has its own characteristics and qualities,  
we have designed a lifestyle inspired by these...



# is BLUE

CALM & COOL  
LUXURIOUS  
PROSPEROUS  
REJUVENATING  
SOCIAL..





# CALM & COOL

blue open skies, lush green environs, well designed campus...  
a life that personifies peace, calm and serenity.

riviera blue is not a home but an **experience** !





# RIVIERA BLUES

Every residence here engulfed in  
greens and lush nature breathes peace !

Welcome to a serene living.







Party, social meets, celebrations; the list is on.  
Riviera Blues is coded with amenities that make social life alive.

A house is not a house till you include the people around it.  
spaces that elevate community living, spaces that include everybody  
from the children to the youngsters to the adults to grandparents.

riviera blues is designed for **everybody** !













1200 MT. WIDE ROAD

1200 MT. WIDE ROAD



### COMMON FACILITIES / AMENITIES

-  EXQUISITE LANDSCAPED GARDEN
-  FULLY EQUIPPED GYMNASIUM
-  SWIMMING POOL
-  MULTIPURPOSE COURT
-  HOME THEATRE
-  INDOOR GAMES
-  PARTY LAWNS
-  CHILDREN'S PLAY AREAS
-  SENIOR CITIZEN SIT OUT

# ZRICKS



## SITE PLAN



900 MT. WIDE ROAD



# LUXURIOUS

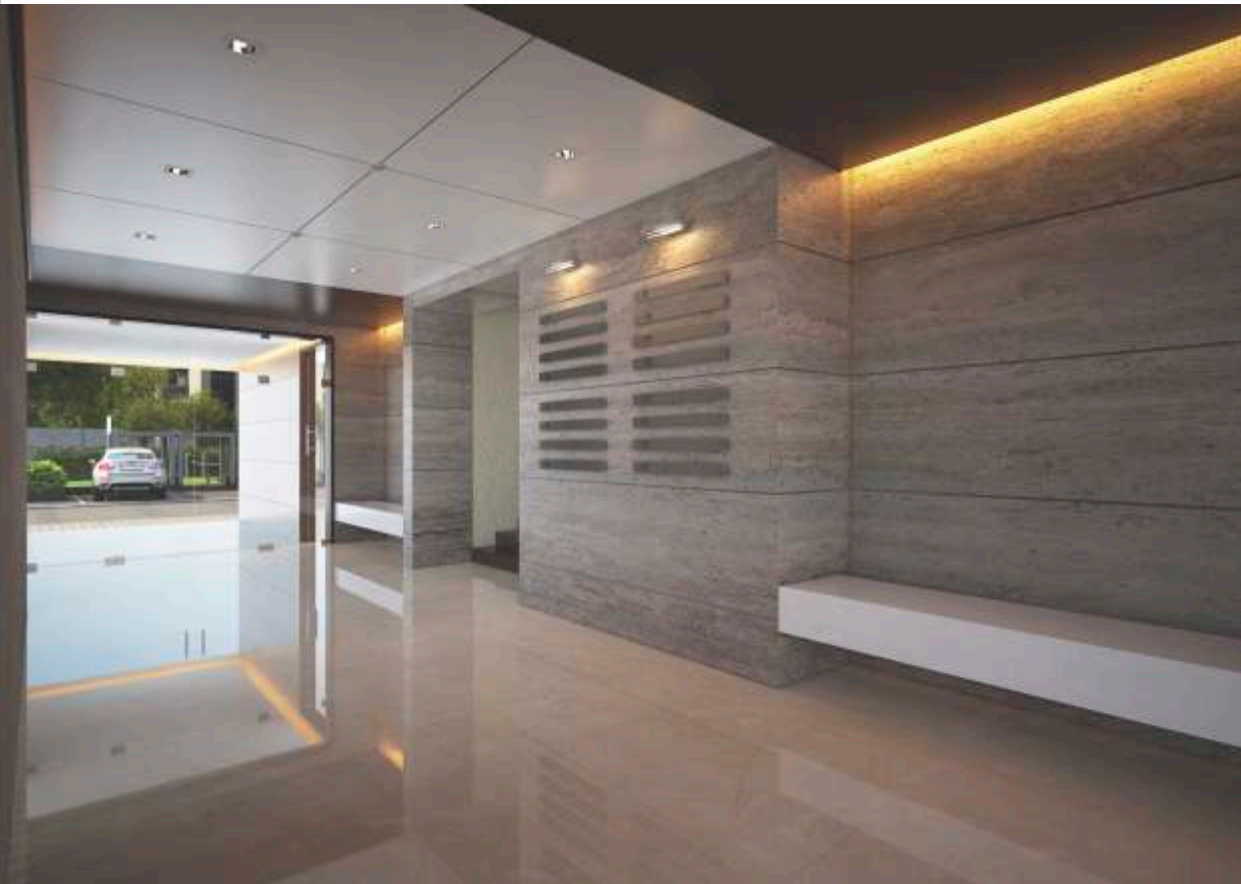

An enormous 4 BHK residential project with abundant space and best in class amenities; is what Riviera Blues made up of. It's an address that marks luxurious lifestyle. Indeed!

Lavish entrance, grand foyers, unmatched finishes, riviera blues is taking luxury to its **pinnacle** !

Chasing ambitions makes life stressful. Yet at Riviera you will de stress yourself through a myriad of leisure options.

Riviera blues has everything to do nothing and pamper your senses. a swimming pool, pleasant sit outs and gymnasium. you name it and we have it exclusively **for your senses** !



# REJUVENATING



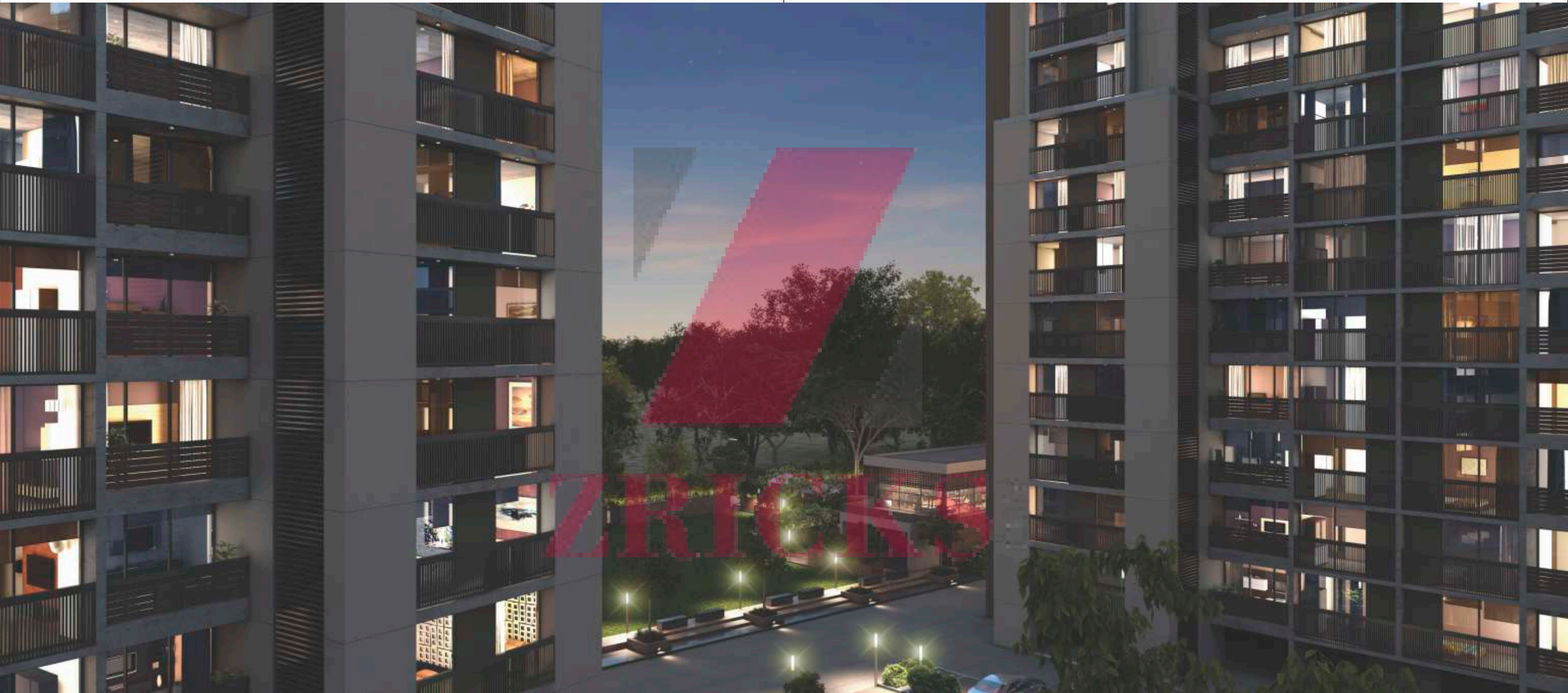

UNIT PLANS



## SALIENT FEATURES

- Fully Air-conditioned Apartments – VRV system
- 2 Automatic elevators for every block
- Well designed Air Conditioned Entrance foyers
- Hi-tech Security System
- Well equipped Fire Hydrant System in every block
- Provision for DTH satellite TV connection
- All internal roads of R.C.C. / Pattern designed Stone Paving
- Allotted Car parking spaces for 2 Cars per apartment

## SPECIFICATIONS

- FLOORING** : Composite Italian Marble or Porcelain Slabs in Living/Dining  
Vitrified tiles in Bed Rooms, Wooden flooring in Master Bedroom, Rustic Tiles in Balcony
- KITCHEN** : Vitrified tiles, Granite platform with S.S. sink, Modular Furniture of International Quality
- DOORS** : Main Door - Polish Natural Veneer with night latch, Bedroom Door - Painted  
Balcony - Sliding anodized aluminum section
- WINDOWS** : Anodized aluminum sliding windows
- TOILETS** : Glazed / Ceramic Tiles upto Lintel Level, Counter Basin / Wall hung basin, Imported Shower Panel  
EWC Couple Closet - Wall-hung (TOTO / equivalent), CP Brass Fittings ( Hans Grohe / Jaquar / equivalent )
- ELECTRIFICATION** : 3 Phase Concealed ISI Copper Wiring with Modular Switches, MCB distribution Panel
- COLOUR** : Internal : Putty Finish, External: 100% Acrylic paint
- AIR-CONDITIONING** : Power Saving VRV System – Daikin / Equivalent





# 4 BHK TYPICAL FLOOR

BLOCK : A-1 & 4 + B-2 & 3  
BLOCK : C-1 & 4 + D-2 & 3



2750 SQ.FT.(S.B.UP)



ZRICKS

NO	SPACES	AREA
1	ENT.FOYER	10'5" X 8'3"
1A	VESTIBULE	5'6" X 9'7"
2	BED ROOM-01	13'9" X 10'10"
2A	TOILET	7'9" X 4'11"
3	DRAWING ROOM	18'6" X 12'10"
3A	VERANDAH	11'10" X 4'11"
4	DINING	10'10" X 12'5"
5	KITCHEN	15'9" X 8'0"

5A	KITCHEN YARD	7'4" X 5'11"
6	G.TOILET	4'11" X 7'5"
7	BED ROOM-02	17'9" X 11'10"
7A	TOILET	12'10" X 5'11"
8	BED ROOM-03	10'10" X 12'10"
9	BED ROOM-04	10'10" X 16'2"
9A	TOILET	5'11" X 8'4"
F.B.	FLOWER BED	19" WIDE

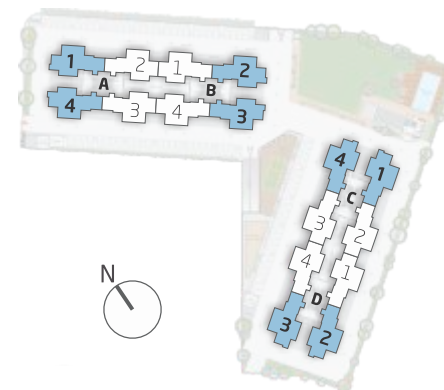





# 4 BHK TYPICAL FLOOR

BLOCK : A-2 & 3 + B-1 & 4  
BLOCK : C-2 & 3 + D-1 & 4



2750 SQ.FT.(S.B.UP)

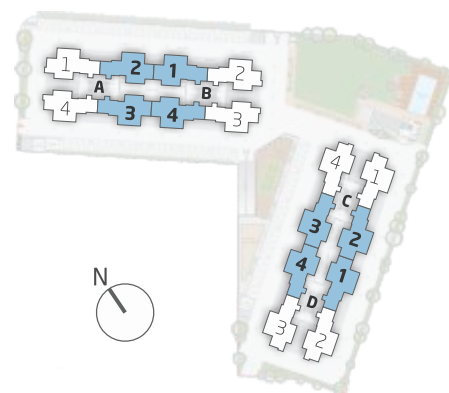

NO	SPACES	AREA		AREA	
1	ENT.FOYER	10'5" X 8'3"	5A	KITCHEN YARD	7'4" X 5'11"
1A	VESTIBULE	5'6" X 9'7"	6	G.TOILET	4'11" X 7'5"
2	BED ROOM-01	13'9" X 10'10"	7	BED ROOM-02	17'9" X 11'10"
2A	TOILET	7'9" X 4'11"	7A	TOILET	12'10" X 5'11"
3	DRAWING ROOM	18'6" X 12'10"	8	BED ROOM-03	10'10" X 12'10"
3A	VERANDAH	11'10" X 4'11"	9	BED ROOM-04	10'10" X 16'2"
4	DINING	10'10" X 12'5"	9A	TOILET	5'11" X 8'4"
5	KITCHEN	15'9" X 8'0"	F.B.	FLOWER BED	19" WIDE



# 4 BHK TOP FLOOR

BLOCK : A-1 & 4 + B-2 & 3  
BLOCK : C-1 & 4 + D-2 & 3

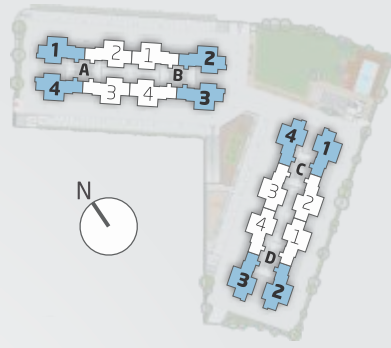

2885 SQ.FT.(S.B.UP)

NO	SPACES	AREA	NO	SPACES	AREA
1	ENT.FOYER	10'5" X 8'3"	5	KITCHEN	15'9" X 8'0"
1A	VESTIBULE	5'6" X 9'7"	5A	KITCHEN YARD	7'4" X 5'11"
2	BED ROOM-01	13'9" X 10'10"	6	G.TOILET	4'11" X 7'5"
2A	TOILET	7'9" X 4'11"	7	BED ROOM-02	17'9" X 11'10"
2B	VERANDAH	12'2" X 5'0"	7A	TOILET	12'10" X 5'11"
3	DRAWING ROOM	18'6" X 12'10"	8	BED ROOM-03	10'10" X 12'10"
3A	VERANDAH	11'10" X 8'0"	9	BED ROOM-04	10'10" X 16'2"
4	DINING	10'10" X 12'5"	9A	TOILET	5'11" X 8'4"
			F.B.	FLOWER BED	19" WIDE

# 4 BHK TOP FLOOR

BLOCK : A-2 & 3 + B-1 & 4  
BLOCK : C-2 & 3 + D-1 & 4

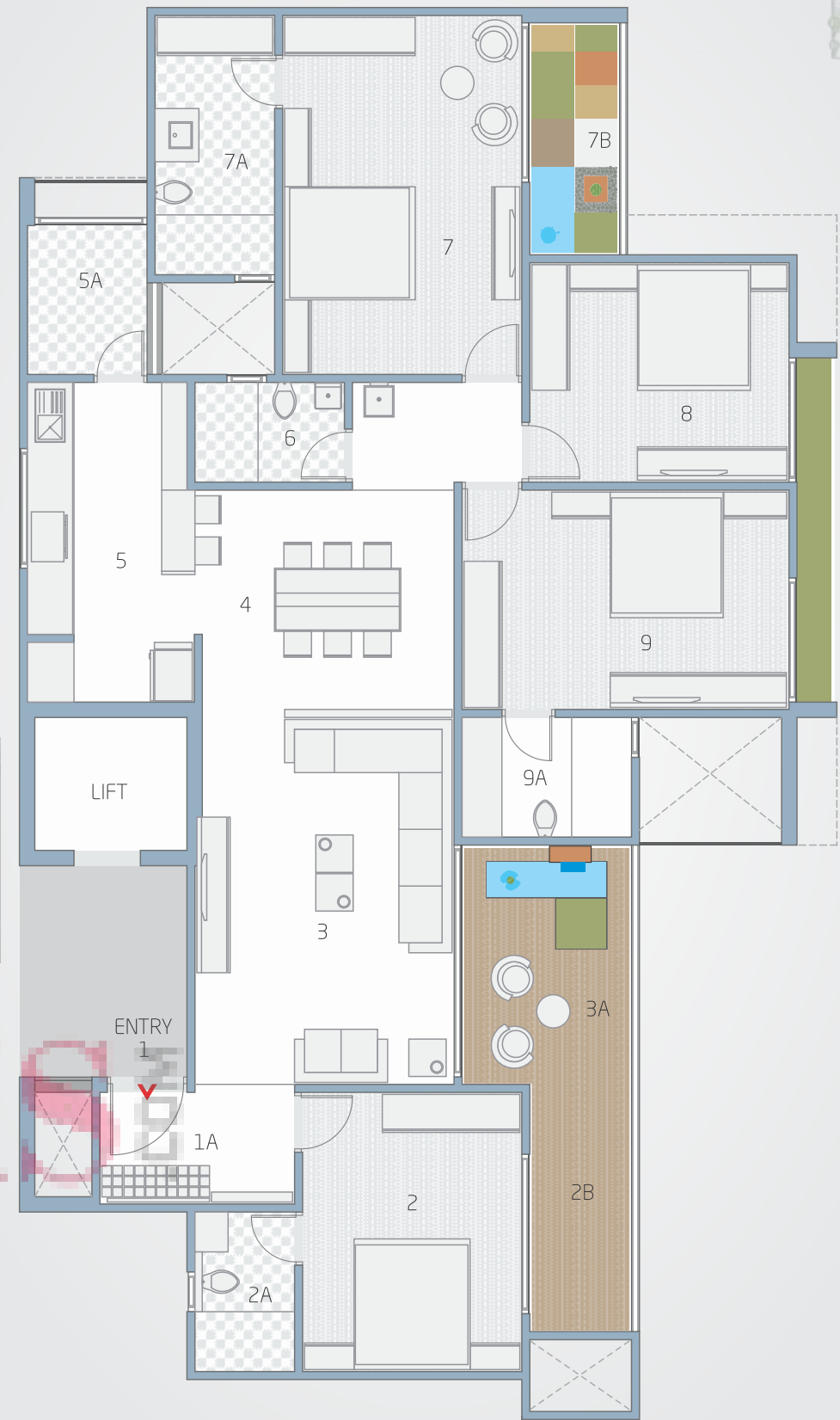
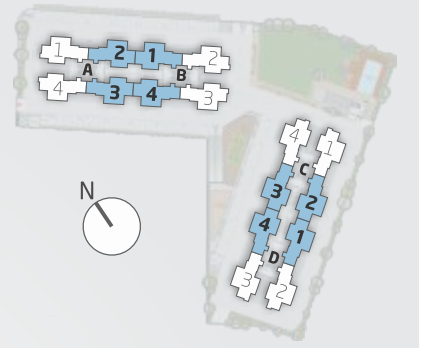

2940 SQ.FT.(S.B.UP)

NO	SPACES	AREA	NO	SPACES	AREA
1	ENT.FOYER	10'5" X 8'3"	5A	KITCHEN YARD	7'4" X 5'11"
1A	VESTIBULE	5'6" X 9'7"	6	G.TOILET	4'11" X 7'5"
2	BED ROOM-01	13'9" X 10'10"	7	BED ROOM-02	17'9" X 11'10"
2A	TOILET	7'9" X 4'11"	7A	TOILET	12'10" X 5'11"
2B	VERANDAH	12'2" X 5'0"	7B	VERANDAH	11'5" X 4'5"
3	DRAWING ROOM	18'6" X 12'10"	8	BED ROOM-03	10'10" X 12'10"
3A	VERANDAH	11'10" X 8'0"	9	BED ROOM-04	10'10" X 16'2"
4	DINING	10'10" X 12'5"	9A	TOILET	5'11" X 8'4"
5	KITCHEN	15'9" X 8'0"	F.B.	FLOWER BED	19" WIDE



# PROSPEROUS

Riviera Blues is located on Corporate Road, Prahladnagar. This stretch of Ahmedabad is witnessing pulsating growth. It's a locale which will attract appreciation over the years thereby, making Riviera a most prospering project.

Moreover, this project is positioned in the vicinity of communal places, enabling you to socialize without a pause.

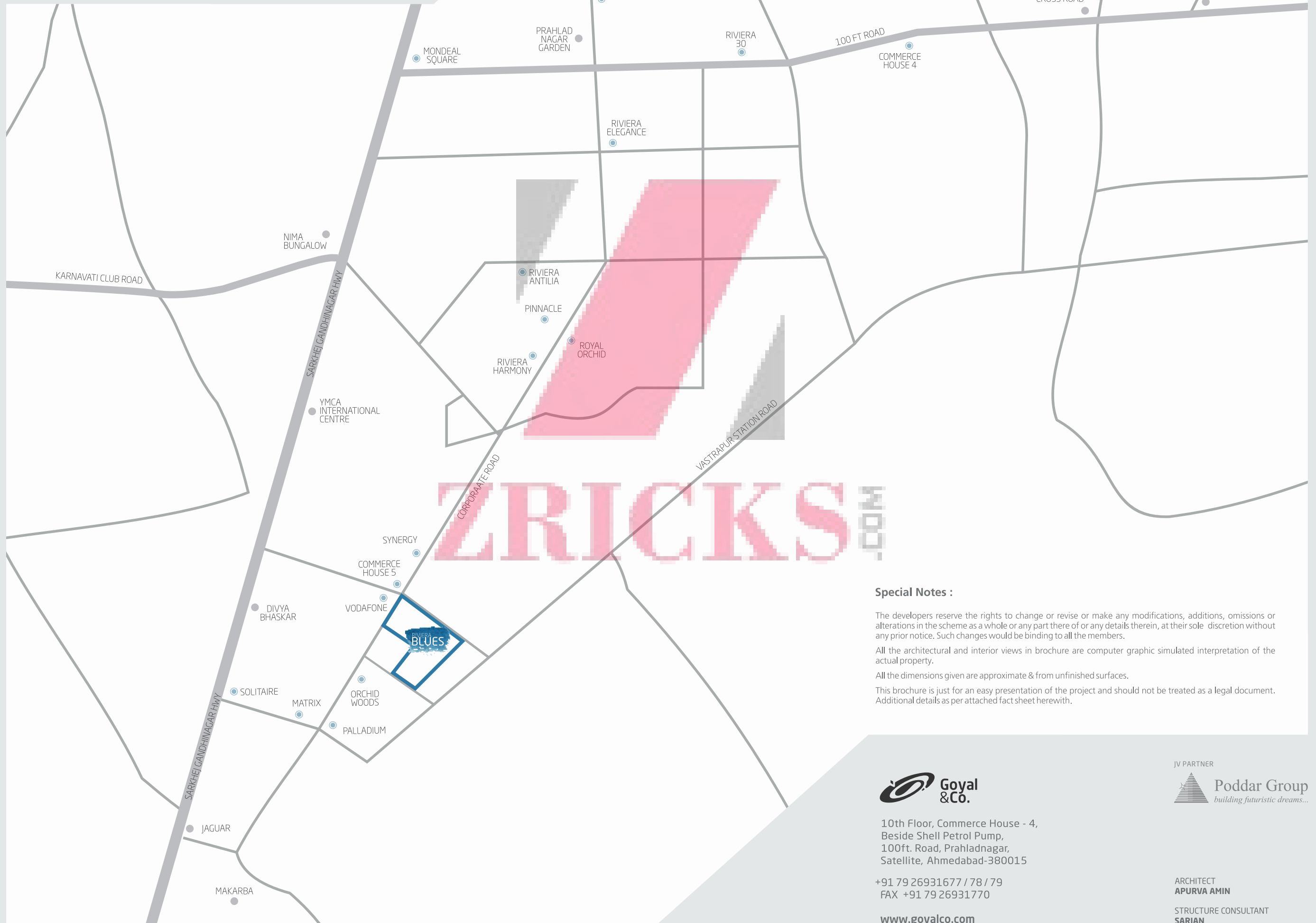

#### Special Notes :

The developers reserve the rights to change or revise or make any modifications, additions, omissions or alterations in the scheme as a whole or any part thereof or any details therein, at their sole discretion without any prior notice. Such changes would be binding to all the members.

All the architectural and interior views in brochure are computer graphic simulated interpretation of the actual property.

All the dimensions given are approximate & from unfinished surfaces.

This brochure is just for an easy presentation of the project and should not be treated as a legal document. Additional details as per attached fact sheet herewith.



10th Floor, Commerce House - 4,  
Beside Shell Petrol Pump,  
100ft. Road, Prahladnagar,  
Satellite, Ahmedabad-380015

+91 79 26931677 / 78 / 79  
FAX +91 79 26931770

[www.goyalco.com](http://www.goyalco.com)

JV PARTNER



ARCHITECT  
**APURVA AMIN**

STRUCTURE CONSULTANT  
**SARJAN**





**ZRICKS**.COM